



# Rosebery House | Floorplans





<b>UNIT 1</b> Total Area (118.2m <sup>2</sup> , 1272ft <sup>2</sup> )
<b>UNIT 2</b> Total Area (162.4m <sup>2</sup> , 1748ft <sup>2</sup> )
<b>UNIT 3</b> Total Area (119.1m <sup>2</sup> , 1282ft <sup>2</sup> )



FLOOR

3rd  
2nd  
1st

GROUND

All measurements are gross internal areas. Room sizes may be subject to minor alterations. Please refer to [roseberylhouse-kt17.com](http://roseberylhouse-kt17.com) for the most up-to-date floor plans.

Head Office:  
IDM Properties LLP,  
Office B, West Gainsborough,  
1 Poole Street, London N1 5EA

+44 (0)20 7739 1650  
[mail@idmproperties.com](mailto:mail@idmproperties.com)  
[idmproperties.com](http://idmproperties.com)



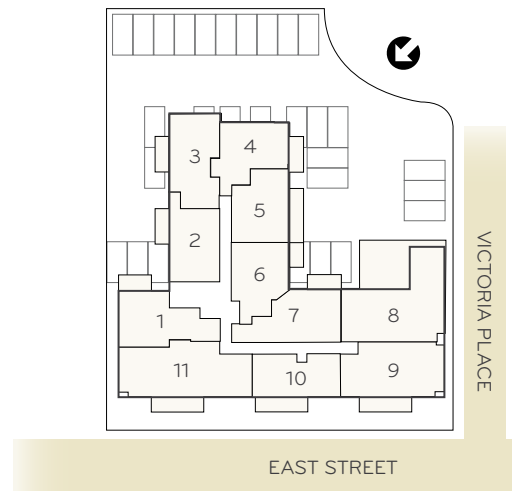

FLOOR

- 3rd
- 2nd
- 1st
- GROUND

All measurements are gross internal areas. Room sizes may be subject to minor alterations. Please refer to [roseberylhouse-kt17.com](http://roseberylhouse-kt17.com) for the most up-to-date floor plans.

Head Office:  
IDM Properties LLP,  
Office B, West Gainsborough,  
1 Poole Street, London N1 5EA

+44 (0)20 7739 1650  
[mail@idmproperties.com](mailto:mail@idmproperties.com)  
[idmproperties.com](http://idmproperties.com)





**APARTMENT 1**  
Total Area (51.3m<sup>2</sup>, 552.2ft<sup>2</sup>)

**Living, Dining, Kitchen**  
3.2m x 6.4m (21.6m<sup>2</sup>, 232.5ft<sup>2</sup>)

**Bedroom**  
2.8m x 3.7m (11.8m<sup>2</sup>, 127.0ft<sup>2</sup>)

ENERGY EFFICIENCY RATING 73C  
ENVIRONMENTAL IMPACT (CO<sub>2</sub>) 76C

**APARTMENT 2**  
Total Area (41.8m<sup>2</sup>, 449.9ft<sup>2</sup>)

**Living, Dining, Kitchen**  
5.5m x 4.2m (23.2m<sup>2</sup>, 249.7ft<sup>2</sup>)

**Bedroom**  
2.7m x 4.0m (13.7m<sup>2</sup>, 147.4ft<sup>2</sup>)

ENERGY EFFICIENCY RATING 76C  
ENVIRONMENTAL IMPACT (CO<sub>2</sub>) 78C

**APARTMENT 3**  
Total Area (53.0m<sup>2</sup>, 570.5ft<sup>2</sup>)

**Living, Dining, Kitchen**  
5.2m x 4.7m (24.9m<sup>2</sup>, 268ft<sup>2</sup>)

**Bedroom**  
3.3m x 3.8m (12.7m<sup>2</sup>, 136.7ft<sup>2</sup>)

ENERGY EFFICIENCY RATING 75C  
ENVIRONMENTAL IMPACT (CO<sub>2</sub>) 78C

**APARTMENT 4**  
Total Area (49.5m<sup>2</sup>, 532.8ft<sup>2</sup>)

**Living, Dining, Kitchen**  
4.6m x 5.1m (25.2m<sup>2</sup>, 271.2ft<sup>2</sup>)

**Bedroom**  
3.1m x 3.9m (11.8m<sup>2</sup>, 127ft<sup>2</sup>)

ENERGY EFFICIENCY RATING 70C  
ENVIRONMENTAL IMPACT (CO<sub>2</sub>) 73C

**APARTMENT 5**  
Total Area (49.5m<sup>2</sup>, 532.8ft<sup>2</sup>)

**Living, Dining, Kitchen**  
6.2m x 5.3m (25.1m<sup>2</sup>, 270.1ft<sup>2</sup>)

**Bedroom**  
4.2m x 2.9m (13.0m<sup>2</sup>, 139.9ft<sup>2</sup>)

ENERGY EFFICIENCY RATING 74C  
ENVIRONMENTAL IMPACT (CO<sub>2</sub>) 77C

**APARTMENT 6**  
Total Area (48.8m<sup>2</sup>, 525.2ft<sup>2</sup>)

**Living, Dining, Kitchen**  
6.4m x 3.2m (22.9m<sup>2</sup>, 246.4ft<sup>2</sup>)

**Bedroom**  
3.7m x 3.2m (13.3m<sup>2</sup>, 143.2ft<sup>2</sup>)

ENERGY EFFICIENCY RATING 77C  
ENVIRONMENTAL IMPACT (CO<sub>2</sub>) 80C

**APARTMENT 7**  
Total Area (56.4m<sup>2</sup>, 607ft<sup>2</sup>)

**Living, Dining, Kitchen**  
3.9m x 5.8m (26.5m<sup>2</sup>, 285.2ft<sup>2</sup>)

**Bedroom**  
3.4m x 4.1m (15.1m<sup>2</sup>, 162.5ft<sup>2</sup>)

ENERGY EFFICIENCY RATING 77C  
ENVIRONMENTAL IMPACT (CO<sub>2</sub>) 79C

**APARTMENT 8**  
Total Area (86.9m<sup>2</sup>, 935.3ft<sup>2</sup>)

**Living, Dining, Kitchen**  
4.4m x 9.0m (38.1m<sup>2</sup>, 410.1ft<sup>2</sup>)

**Bedroom 1**  
3.9m x 2.9m (14.8m<sup>2</sup>, 159.3ft<sup>2</sup>)

**Bedroom 2**  
3.2m x 3.2m (13.0m<sup>2</sup>, 139.9ft<sup>2</sup>)

ENERGY EFFICIENCY RATING 68D  
ENVIRONMENTAL IMPACT (CO<sub>2</sub>) 71C

**APARTMENT 9**  
Total Area (68.8m<sup>2</sup>, 736.2ft<sup>2</sup>)

**Living, Dining, Kitchen**  
5.3m x 4.6m (24.0m<sup>2</sup>, 258.3ft<sup>2</sup>)

**Bedroom 1**  
3.2m x 3.6m (16.6m<sup>2</sup>, 178.7ft<sup>2</sup>)

**Bedroom 2**  
3.1m x 2.5m (9.6m<sup>2</sup>, 103.3ft<sup>2</sup>)

ENERGY EFFICIENCY RATING 74C  
ENVIRONMENTAL IMPACT (CO<sub>2</sub>) 76C

**APARTMENT 10**  
Total Area (48.0m<sup>2</sup>, 516.6ft<sup>2</sup>)

**Living, Dining, Kitchen**  
5.9m x 4.7m (26.0m<sup>2</sup>, 279.9ft<sup>2</sup>)

**Bedroom**  
3.4m x 2.8m (10.6m<sup>2</sup>, 114.1ft<sup>2</sup>)

ENERGY EFFICIENCY RATING 76C  
ENVIRONMENTAL IMPACT (CO<sub>2</sub>) 78C

**APARTMENT 11**  
Total Area (84.8m<sup>2</sup>, 912.7ft<sup>2</sup>)

**Living, Dining, Kitchen**  
5.3m x 5.3m (28.6m<sup>2</sup>, 307.8ft<sup>2</sup>)

**Bedroom 1**  
3.4m x 3.1m (13.7m<sup>2</sup>, 147.4ft<sup>2</sup>)

**Bedroom 2**  
2.8m x 3.9m (8.2m<sup>2</sup>, 88.3ft<sup>2</sup>)

**Bedroom 3**  
2.7m x 2.4m (11.5m<sup>2</sup>, 123.8ft<sup>2</sup>)

ENERGY EFFICIENCY RATING 74C  
ENVIRONMENTAL IMPACT (CO<sub>2</sub>) 76C



# Second Floor | Rosebery House | Apartments 12-22



## FLOOR

3rd  
2nd  
1st  
GROUND

All measurements are gross internal areas. Room sizes may be subject to minor alterations. Please refer to [roseberylhouse-kt17.com](http://roseberylhouse-kt17.com) for the most up-to-date floor plans.

Head Office:  
IDM Properties LLP,  
Office B, West Gainsborough,  
1 Poole Street, London N1 5EA

+44 (0)20 7739 1650  
[mail@idmproperties.com](mailto:mail@idmproperties.com)  
[idmproperties.com](http://idmproperties.com)





**APARTMENT 12**  
Total Area (55.2m<sup>2</sup>, 594.1ft<sup>2</sup>)

**Living, Dining, Kitchen**  
3.4m x 6.0m (22.3m<sup>2</sup>, 240.0ft<sup>2</sup>)

**Bedroom**  
3.9m x 5.4m (18.1m<sup>2</sup>, 194.8ft<sup>2</sup>)

ENERGY EFFICIENCY RATING 70C  
ENVIRONMENTAL IMPACT (CO<sub>2</sub>) 73C

**APARTMENT 13**  
Total Area (53.0m<sup>2</sup>, 570.5ft<sup>2</sup>)

**Living, Dining, Kitchen**  
5.7m x 4.8m (27.0m<sup>2</sup>, 290.6ft<sup>2</sup>)

**Bedroom**  
2.8m x 4.1m (14.7m<sup>2</sup>, 158.2ft<sup>2</sup>)

ENERGY EFFICIENCY RATING 73C  
ENVIRONMENTAL IMPACT (CO<sub>2</sub>) 75C

**APARTMENT 14**  
Total Area (50.7m<sup>2</sup>, 545.7ft<sup>2</sup>)

**Living, Dining, Kitchen**  
5.1m x 4.7m (24.6m<sup>2</sup>, 264.8ft<sup>2</sup>)

**Bedroom**  
3.5m x 3.2m (11.8m<sup>2</sup>, 127.0ft<sup>2</sup>)

ENERGY EFFICIENCY RATING 73C  
ENVIRONMENTAL IMPACT (CO<sub>2</sub>) 75C

**APARTMENT 15**  
Total Area (48.8m<sup>2</sup>, 525.2ft<sup>2</sup>)

**Living, Dining, Kitchen**  
4.8m x 5.0m (25.7m<sup>2</sup>, 276.6ft<sup>2</sup>)

**Bedroom**  
3.0m x 3.9m (11.8m<sup>2</sup>, 127.0ft<sup>2</sup>)

ENERGY EFFICIENCY RATING 68D  
ENVIRONMENTAL IMPACT (CO<sub>2</sub>) 71C

**APARTMENT 16**  
Total Area (50.2m<sup>2</sup>, 540.3ft<sup>2</sup>)

**Living, Dining, Kitchen**  
5.6m x 5.5m (25.5m<sup>2</sup>, 274.4ft<sup>2</sup>)

**Bedroom**  
3.8m x 2.9m (13.3m<sup>2</sup>, 143.2ft<sup>2</sup>)

ENERGY EFFICIENCY RATING 70C  
ENVIRONMENTAL IMPACT (CO<sub>2</sub>) 73C

**APARTMENT 17**  
Total Area (49.4m<sup>2</sup>, 531.7ft<sup>2</sup>)

**Living, Dining, Kitchen**  
6.6m x 3.0m (21.8m<sup>2</sup>, 234.6ft<sup>2</sup>)

**Bedroom**  
4.1m x 3.2m (14.6m<sup>2</sup>, 157.0ft<sup>2</sup>)

ENERGY EFFICIENCY RATING 76C  
ENVIRONMENTAL IMPACT (CO<sub>2</sub>) 78C

**APARTMENT 18**  
Total Area (51.3m<sup>2</sup>, 552.2ft<sup>2</sup>)

**Living, Dining, Kitchen**  
3.6m x 5.5m (23.6m<sup>2</sup>, 254.0ft<sup>2</sup>)

**Bedroom**  
3.4m x 3.7m (13.4m<sup>2</sup>, 144.2ft<sup>2</sup>)

ENERGY EFFICIENCY RATING 75C  
ENVIRONMENTAL IMPACT (CO<sub>2</sub>) 78C

**APARTMENT 19**  
Total Area (68.4m<sup>2</sup>, 736.3ft<sup>2</sup>)

**Living, Dining, Kitchen**  
6.0m x 4.6m (27.9m<sup>2</sup>, 300.3ft<sup>2</sup>)

**Bedroom 1**  
3.3m x 3.8m (13.4m<sup>2</sup>, 144.2ft<sup>2</sup>)

**Bedroom 2**  
2.3m x 2.9m (8.9m<sup>2</sup>, 95.8ft<sup>2</sup>)

ENERGY EFFICIENCY RATING 66D  
ENVIRONMENTAL IMPACT (CO<sub>2</sub>) 70C

**APARTMENT 20**  
Total Area (68.0m<sup>2</sup>, 731.9ft<sup>2</sup>)

**Living, Dining, Kitchen**  
5.4m x 4.4m (25.3m<sup>2</sup>, 272.3ft<sup>2</sup>)

**Bedroom 1**  
3.2m x 3.9m (15.8m<sup>2</sup>, 170.0ft<sup>2</sup>)

**Bedroom 2**  
3.0m x 2.2m (9.2m<sup>2</sup>, 99.0ft<sup>2</sup>)

ENERGY EFFICIENCY RATING 69C  
ENVIRONMENTAL IMPACT (CO<sub>2</sub>) 72C

**APARTMENT 21**  
Total Area (45.9m<sup>2</sup>, 494.0ft<sup>2</sup>)

**Living, Dining, Kitchen**  
5.9m x 4.4m (23.7m<sup>2</sup>, 255.1ft<sup>2</sup>)

**Bedroom**  
3.7m x 3.1m (13.3m<sup>2</sup>, 143.2ft<sup>2</sup>)

ENERGY EFFICIENCY RATING 73C  
ENVIRONMENTAL IMPACT (CO<sub>2</sub>) 76C

**APARTMENT 22**  
Total Area (87.9m<sup>2</sup>, 946.1ft<sup>2</sup>)

**Living, Dining, Kitchen**  
4.8m x 6.4m (32.5m<sup>2</sup>, 349.8ft<sup>2</sup>)

**Bedroom 1**  
3.4m x 3.9m (13.4m<sup>2</sup>, 144.2ft<sup>2</sup>)

**Bedroom 2**  
3.9m x 2.7m (10.4m<sup>2</sup>, 144.2ft<sup>2</sup>)

**Bedroom 3**  
2.5m x 3.9m (11.5m<sup>2</sup>, 123.8ft<sup>2</sup>)

ENERGY EFFICIENCY RATING 69C  
ENVIRONMENTAL IMPACT (CO<sub>2</sub>) 72C

# Third Floor | Rosebery House | Apartments 23-30

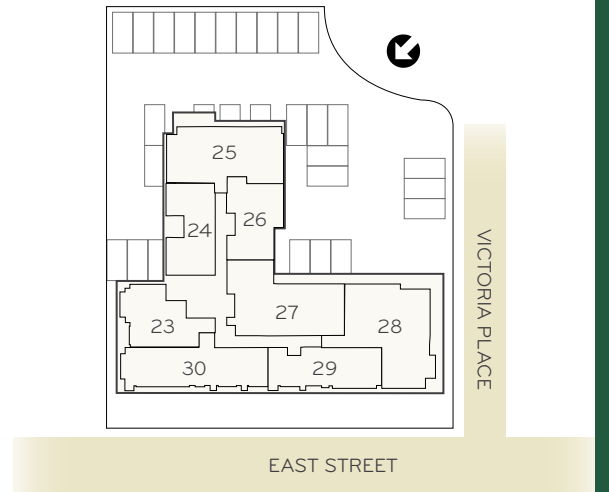

## FLOOR

- 3rd
- 2nd
- 1st
- GROUND

All measurements are gross internal areas. Room sizes may be subject to minor alterations. Please refer to [roseberylhouse-kt17.com](http://roseberylhouse-kt17.com) for the most up-to-date floor plans.

Head Office:  
IDM Properties LLP,  
Office B, West Gainsborough,  
1 Poole Street, London N1 5EA

+44 (0)20 7739 1650  
[mail@idmproperties.com](mailto:mail@idmproperties.com)  
[idmproperties.com](http://idmproperties.com)





**APARTMENT 23**  
Total Area (51.1m<sup>2</sup>, 550.0ft<sup>2</sup>)

**Living, Dining, Kitchen**  
6.2m x 3.9m (23.8m<sup>2</sup>, 256.1ft<sup>2</sup>)

**Bedroom**  
4.3m x 2.7m (12.3m<sup>2</sup>, 132.4ft<sup>2</sup>)

ENERGY EFFICIENCY RATING 80C  
ENVIRONMENTAL IMPACT (CO<sub>2</sub>) 82B

**APARTMENT 24**  
Total Area (49.4m<sup>2</sup>, 531.7ft<sup>2</sup>)

**Living, Dining, Kitchen**  
5.2m x 6.0m (27.3m<sup>2</sup>, 293.9ft<sup>2</sup>)

**Bedroom**  
3.2m x 4.2m (13.1m<sup>2</sup>, 141.0ft<sup>2</sup>)

ENERGY EFFICIENCY RATING 79C  
ENVIRONMENTAL IMPACT (CO<sub>2</sub>) 82B

**APARTMENT 25**  
Total Area (81.9m<sup>2</sup>, 881.5ft<sup>2</sup>)

**Living, Dining, Kitchen**  
7.2m x 3.3m (22.7m<sup>2</sup>, 244.3ft<sup>2</sup>)

**Bedroom 1**  
3.3m x 3.8m (16.0m<sup>2</sup>, 172.2ft<sup>2</sup>)

**Bedroom 2**  
3.1m x 3.0m (11.3m<sup>2</sup>, 121.6ft<sup>2</sup>)

**Bedroom 3**  
3.3m x 2.7m (11.8m<sup>2</sup>, 127.0ft<sup>2</sup>)

ENERGY EFFICIENCY RATING 78C  
ENVIRONMENTAL IMPACT (CO<sub>2</sub>) 80C

**APARTMENT 26**  
Total Area (48.3m<sup>2</sup>, 519.8ft<sup>2</sup>)

**Living, Dining, Kitchen**  
5.1m x 5.2m (25.7m<sup>2</sup>, 276.6ft<sup>2</sup>)

**Bedroom**  
3.3m x 3.2m (13.1m<sup>2</sup>, 141.0ft<sup>2</sup>)

ENERGY EFFICIENCY RATING 79C  
ENVIRONMENTAL IMPACT (CO<sub>2</sub>) 81B

**APARTMENT 27**  
Total Area (86.8m<sup>2</sup>, 934.3ft<sup>2</sup>)

**Living, Dining, Kitchen**  
5.2m x 6.5m (30.1m<sup>2</sup>, 223.9ft<sup>2</sup>)

**Bedroom 1**  
3.2m x 3.4m (14.5m<sup>2</sup>, 156.0ft<sup>2</sup>)

**Bedroom 2**  
2.7m x 3.9m (12.1m<sup>2</sup>, 130.2ft<sup>2</sup>)

**Bedroom 3**  
2.5m x 3.5m (9.8m<sup>2</sup>, 105.5ft<sup>2</sup>)

ENERGY EFFICIENCY RATING 79C  
ENVIRONMENTAL IMPACT (CO<sub>2</sub>) 81B

**APARTMENT 28**  
Total Area (94.7m<sup>2</sup>, 1019.3ft<sup>2</sup>)

**Living, Dining, Kitchen**  
5.6m x 6.0m (34.0m<sup>2</sup>, 365.9ft<sup>2</sup>)

**Bedroom 1**  
3.7m x 2.7m (13.2m<sup>2</sup>, 142.1ft<sup>2</sup>)

**Bedroom 2**  
2.8m x 3.5m (11.5m<sup>2</sup>, 123.8ft<sup>2</sup>)

**Bedroom 3**  
3.2m x 2.9m (12.1m<sup>2</sup>, 130.2ft<sup>2</sup>)

ENERGY EFFICIENCY RATING 78C  
ENVIRONMENTAL IMPACT (CO<sub>2</sub>) 80C

**APARTMENT 29**  
Total Area (54.2m<sup>2</sup>, 583.3ft<sup>2</sup>)

**Living, Dining, Kitchen**  
6.9m x 4.2m (27.6m<sup>2</sup>, 297.0ft<sup>2</sup>)

**Bedroom**  
3.9m x 3.8m (16.4m<sup>2</sup>, 176.5ft<sup>2</sup>)

ENERGY EFFICIENCY RATING 81B  
ENVIRONMENTAL IMPACT (CO<sub>2</sub>) 83B

**APARTMENT 30**  
Total Area (72.2m<sup>2</sup>, 777.1ft<sup>2</sup>)

**Living, Dining, Kitchen**  
7.9m x 4.2m (34.9m<sup>2</sup>, 375.6ft<sup>2</sup>)

**Bedroom 1**  
2.9m x 4.4m (13.6m<sup>2</sup>, 146.4ft<sup>2</sup>)

**Bedroom 2**  
2.9m x 3.0m (9.5m<sup>2</sup>, 102.2ft<sup>2</sup>)

ENERGY EFFICIENCY RATING 80C  
ENVIRONMENTAL IMPACT (CO<sub>2</sub>) 82B